



12310/22 Merivale Street South Brisbane QLD

2  2  1 

Welcome to Ivy & Eve on Merivale Street, South Brisbane - a contemporary, vibrant residence designed for the astute buyer seeking a lifestyle of comfort, luxury, and convenience.

Type : Apartment
Building Size : 80 sqm
View : <https://www.aumr.com.au/1P5442>

This spacious two-bedroom, two-bathroom apartment offers the perfect blend of modern style and urban sophistication. Featuring:

- Brisbane State High School catchment zone
- Fully furnished
- An open kitchen equipped with European appliances, flowing seamlessly into the dining and living areas.
- A generously sized balcony for outdoor relaxation.
- Laundry and ample storage near the entrance.
- Beautiful polished oak vinyl plank flooring guiding you

[For full version visit the website](https://www.aumr.com.au)

<https://www.aumr.com.au>

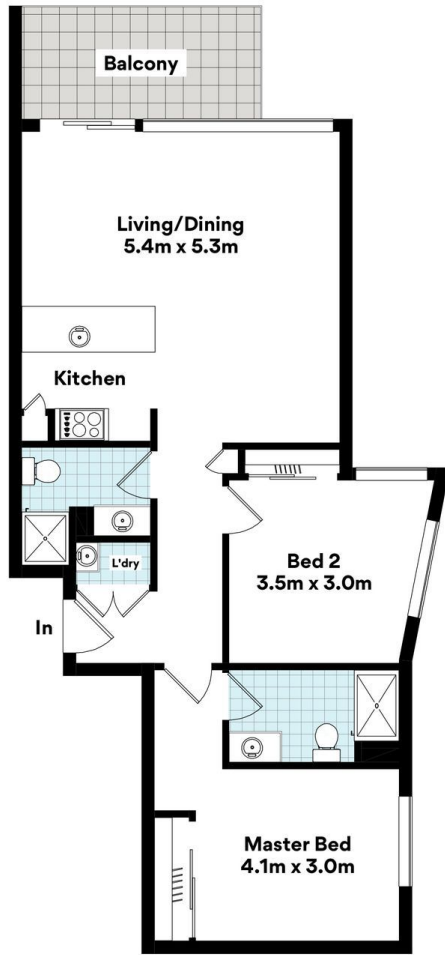

**12310/22 Merivale St,
South Brisbane**



FLOOR AREA SIZES

Internal 80m² | External 8m² | Total 88m²

Whilst every attempt has been made to ensure the accuracy of the floor plans contained here, measurements of doors, windows, rooms and any other items are approximate and no responsibility is taken for any error, omission or misstatement.

These plans are for representation purposes only. Provided by primepixels.com.au